



The 75th IIW Annual Assembly and International Conference

17-22 July 2022 | Tokyo Daiba, Japan

IC Collaborative Expo Corner in Japan International Welding Show

13-16 July 2022 | Tokyo Big Sight, Japan

Innovative Welding and Joining Technologies
to achieve Carbon Neutrality and
promote Sustainable Development



Hosted by



<https://www.iiw2022.com>

Supported by Tokyo Convention & Visitors Bureau

Content

| | |
|---|----|
| General Information | 3 |
| Information about Entering into Japan | 6 |
| Welcome Message | 8 |
| Welcome to Japan | 10 |
| How to Get to Tokyo | 11 |
| Transportation & Distance | 12 |
| Useful Information | 14 |
| Registration..... | 16 |
| Accomodation | 17 |
| IIW2022 Schedule | 18 |
| Technical Commissions & Working Units | 19 |
| IIW2022 International Conference | 20 |
| Collaborative Event..... | 21 |
| Social Plans | 22 |
| Technical Visits | 24 |
| Grand Nikko Tokyo Daiba | 25 |
| IIW Member Countries | 29 |
| Sponsors | 30 |

General Information

Date 17-22 July 2022 (Registration & BoD meeting start from the afternoon of 16 July.)
13-16 July 2022 : IC Collaborative Expo Corner in Japan International Welding Show

Venue Grand Nikko Tokyo Daiba, Tokyo, Japan
Tokyo Big Sight, Japan

Organizer Japan Institute of Welding
Japan Welding Society, The Japan Welding Engineering Society

Attendees 1,000 expected

Annual Assembly & International Conference The programs of the IIW Annual Assembly and International Conference are composed of International Conference (IC) and Working Unit (WU). To attend both programs, full registration is required. IC Collaborative Expo Corner is included in the registration fee of IC.

International Conference IIW2022 International Conference on Welding and Joining
Theme and Topics: Innovative Welding and Joining Technologies to achieve Carbon Neutrality and promote Sustainable Development

- 1 Welding and joining technology to achieve hydrogen society**
Hydrogen supply chain:
Hydrogen fuel stations, Hydrogen carriers, Plants, etc.
Utilization of hydrogen:
Hydrogen vehicles, Hydrogen turbine
- 2 Welding and joining technology for the use of fusion energy**
ITER (Nuclear fusion and Future reactor, etc)
- 3 Welding and joining technology for the use of natural energy**
Offshore wind power generation
- 4 Engineering revolution with 3D Additive Manufacturing (AM) technology**
- 5 Innovative new materials and their welding and joining technologies**
- Weight reduction of automobiles by new materials and their weld joining technology
(e.g., ultrahigh- strength steel, etc.)
- 6 Automation of production by Digital transformation (DX) (building, shipbuilding)**
- Factory robot welding and on-site robot welding in steel structure construction
- IoT in shipbuilding (in-line inspection of welding, etc.)
- Smart factory in welding shop

Working Units (WU)

| No. | Contents | No. | Contents |
|--------------|---|--------------|--|
| C-I | Additive Manufacturing, Surfacing and Thermal Cutting | C-II | Arc Welding and Filler Metals |
| C-III | Resistance Welding, Solid State Welding and Allied Joining Processes | C-IV | Power Beam Processes |
| C-V | Non-destructive Testing and Quality Assurance of Welded Products | C-VI | Terminology |
| C-VII | Research Developments and Applications in Micro and Nano joining Technologies | C-VIII | Health, Safety and Environment |
| C-IX | Behavior of Metals Subjected to Welding | C-X | Structural Performances of Welded Joint - Fracture Avoidance |
| C-XI | Pressure Vessels, Boilers and Pipelines | C-XII | Arc Welding Processes |
| C-XIII | Fatigue of Welded Components and Structures | C-XIV | Education and Training |
| C-XV | Design, Analysis and Fabrication of Welded Structures | C-XVI | Polymer Joining and Adhesive Technology |
| C-XVII | Brazing, Soldering and Diffusion Bonding | C-XVIII | Quality Management in Welding and Allied Processes |
| IAB/ Group A | Education, Training and Qualification | IAB/ Group B | Implementation, Authorization |
| IAB/MM | IAB Members Meeting | | |



General Information

What is IIW?

The International Institute of Welding (IIW) was founded in 1948 by the welding institutes or societies of 13 countries that considered it crucial to make more rapid scientific and technical progress possible on a global basis. The IIW membership today comprises welding associations from 49 countries worldwide, with ever more nations continually indicating interest.

Mission

To advance welding and joining through a worldwide network

Vision

The leading global community linking industry, research and education to the advancement of welding and joining for a safer and sustainable world

Our 'must win' battles to:

- Have an Education, Training, Qualification and Certification (ETQ&C) system which meets the needs of industry and IIW members
- Implement an effective organisational and management structure
- Improve IIW's visibility and impact through effective communication and marketing
- Ensure the industrial relevance of IIW research best practice development and standardisation activities
- Increase the value of involvement to all IIW stakeholders

The IIW is a not-for-profit organisation governed by the Italian law; the members are welding institutes and associations representing their own Countries.

For more information, please visit the website below:

What is IIW? (International Institute of Welding)

<http://iiwelding.org/about-iiw>

Procedure for Hybrid Meeting

In principal, the physical meeting is requested.

Alternatively, you may attend the meeting with Zoom-webinar and Online voting system at a local time. The contents of the meeting will be recorded by Zoom system and be watched by On Demand Broadcasting later.

Q.&A. will be available by e-mail via ODB system.

Online Presenters must send the presentation to the local Secretariat at least 7 days before the meeting to avoid Online troubles.

Local staffs will support the Zoom operation with pre-recorded documents.

If you cannot visit Japan due to personal reasons or regulations of your affiliation, please participate online.

Information about Entering into Japan

Immigration Restriction in Japan

Applies from Mar. 1, 2022

The regulation keeps changing, so please check on the latest information of the Japanese government.

- Only the residents from the **7 Designated* countries** are required for **3 days quarantine excluding the entry date to Japan**

* **Designated 7 countries** : Applies at April 6, 2022

Egypt, Pakistan, Russia, Republic of Korea, Sri Lanka, Vietnam, Turkey

- The residents with 3 times vaccination from the other countries are required **no quarantine**

| Arriving from | Valid vaccination certificateng *1 | Day 0 (entry date) | Days 1 to 3 | Days 4 to 7 |
|--|--|----------------------------|--|---|
| Designated country/region? YES | No | Test at airport quarantine | - Quarantine at government-designated accommodations *2 - Quarantine ends if test results at accommodation facilities on third day are negative when leaving *3 | No quarantine |
| | YES (proof of triple vaccination with designated vaccines) | Test at airport quarantine | - Quarantine at home/accommodations *2 (if not taking self-test after three days after entering Japan) | Quarantine shortened if you receive notice of end of quarantine |
| Designated country/region NO | No | Test at airport quarantine | - Quarantine at home/accommodations *2 (if not taking self-test after three days after entering Japan) | Quarantine shortened if you receive notice of end of quarantine |
| | | Test at airport quarantine | - Quarantine at home/accommodations *2 - Take self-test after three days after entering Japan, submit result (if negative) to Health Monitoring Center for Overseas Entrants (HCO) *3 | Quarantine shortened if you receive notice of end of quarantine |
| | YES (proof of triple vaccination with designated vaccines) | Test at airport quarantine | - No quarantine required | |

NOTE-1) Arrival Certificate of PCR test within 72 hours before leaving for Japan.

NOTE-2) Returning: PCR test*4 might be required before your departure from Japan by your country. We strongly recommend you to check the regulation of your country.

*1: The vaccination certificate is valid only if criteria ① to ④ below are met. (Please see the [detailed information by Japanese government](#))

- ① The certificate must be issued by a government or public institution.
- ② The following items must be indicated in Japanese or English: Name, date of birth, vaccine name/manufacturer, date of vaccination, number of doses administered
- ③ The certificate must clearly indicate that you have received two doses from among the following vaccines (vaccine name/manufacturer):

- Comirnaty/Pfizer
- COVID 19 Vaccine Moderna Moderna
- COVAXIN/Bharat Biotech
- Vaxzevria/AstraZeneca
- Janssen COVID 19 Vaccine/Janssen
- Nuvaxovid/Novavax

* Regarding the application of measures based on Japan's Enhanced Border Measure (27), Comirnaty (manufactured by Fosun Pharma/BioNTech) and Covishield (manufactured by the Serum Institute of India with technology from AstraZeneca) will be treated as identical to Comirnaty/Pfizer and Vaxzevria/AstraZeneca, respectively.

- ④ The certificate must clearly indicate that you have received at a third dose, with it being one of the following vaccines (vaccine name/manufacturer):

- Comirnaty/Pfizer
- COVID 19 Vaccine Moderna Moderna
- Nuvaxovid/Novavax

Information about Entering into Japan

* Regarding the application of measures based on Japan's Enhanced Border Measure (27), Comirnaty (manufactured by Fosun Pharma/BioNTech) will be treated as identical to Comirnaty/Pfizer.

- *2: JIW(Japan Institute of Welding) have designated Tokyo Bay Ariake Washington Hotel as for Quarantine.
- *3: If the PCR test result is positive, participants are planned be designated to move to stay/ keep staying at the Tokyo Bay Ariake Washington Hotel, and participate online.
- *4: If your country requires PCR test, PCR Test Desk will be set on the 1F floor of the venue during 17th and 22nd July to provide you smooth assistance of PCR test reservation and/or Taxi service. Please check your country's entry requirement, and If you need PCR certification, we would organize to book a medical clinic accordingly.

| Medical Clinic | Shiba Kokusai Clinic *Clinic is subject to change |
|------------------------|--|
| Service Fee | JPY 40,000 |
| Booking Deadline | 4 day prior to test day |
| Cancelation Policy | 3 day prior to test day~: 100% of total amount |
| Notification of Result | Perform test in the morning: Receive the result in the evening Perform test in the afternoon: Receive the result following day *Notification of result is subject to change. |

For more details, please review the document, "[Japanese COVID 19 border measures change on March 1, 2022](#)" by Quarantine Station, Ministry of Health, Labour and Welfare, Japanese Government.

It is possible for family members accompanying foreign nationals to apply and enter Japan with the New Measures.

For the measures for returning to your country from Japan, please check on your country's updated information issued by your country's government.

If you cannot visit Japan due to personal reasons or regulations of your affiliation, please participate online.

Information about Entering into Japan

(Border measures to prevent the spread of novel corona-virus: COVID-19.)
https://www.mofa.go.jp/ca/fna/page4e_001053.html

Regulations on Mandatory Quarantine

After entering to Japan, you must isolate yourself at your accommodation for a certain period. The regulation of the isolation period changes depending on the COVID-19 situation. For the updated information, please visit the website below: <https://www.hco.mhlw.go.jp/en/>

For the updated information, please visit the official website of IIW2022 Tokyo.
<https://www.iw2022.com/>

Welcome Message

On behalf of the organizing committee of the 75th IIW Annual Assembly and International Conference 2022 in Tokyo, Japan, I am honored to host the most influential event for the global fabrication industries involving in welding and joining technology, and delighted to welcome participants from all over the world.

Tokyo is the capital of Japan and the famous metropolis where many tower buildings stand close together at a glance. But inside there are plenty of unique cultures fostered and inherited from Edo period for longer than 400 years. Then, we are preparing the elaborate plans that all participants will find out and enjoy various Japanese cultures: sightseeing places, cuisine, entertainments, etc.

Obviously, we have been struggling with the climate change for long years before Paris Agreement. In order to protect global environment. In October 2020, Japanese government declared the goal of realizing a carbon-neutral, decarbonized society by 2050. Subsequently, the Green Growth Strategy was formulated to make explicit current challenges and future actions by several fields: Energy, Transport, Manufacturing, etc. Then, the International Conference “Innovative Welding and Joining Technologies to achieve Carbon Neutrality and promote Sustainable Development” will be firstly held to focus on direction of welding and joining technologies for global contribution to Carbon Neutrality.

Under careful COVID-19 control, you will real-meet each other and participate in fruitful and deep discussion in International Conference and Technical Commission meetings related with your expertise. I am sure that all participants will make globally strong network through friendly communications in technical meetings and various excited events.

I look forward to seeing you in Tokyo in July 2022 for the best IIW Conference and Assembly.



Yoshinori Hirata

Chairman of the Organizing Committee of the 75th IIW Annual Assembly and International Conference 2022 in Tokyo, Japan

Professor Emeritus, Dr. Eng., Osaka University

Welcome Message

IIW 2022 International Conference on Welding and Joining

Innovative Welding and Joining Technologies to achieve Carbon Neutrality and promote Sustainable Development

The goal of “*carbon neutrality*”, zero net greenhouse gas emissions, by 2050 has been declared by more than 120 countries around the world, and political measures towards decarbonization have been proposed in each country. Welding and joining technologies, which are essential in manufacturing industries, need to join the tide of the times and metamorphose into new technologies amenable to attaining carbon neutrality.

The Japan Institute of Welding will host the IIW International Conference on Welding and Joining in Tokyo on 17-18 July 2022. The central theme of the conference is “Innovative Welding and Joining Technologies to achieve Carbon Neutrality and promote Sustainable Development”. The conference in Tokyo will be a historic and innovative event that leads the 75th IIW Annual Assembly in the week following the Japan International Welding Show (JIWS) 2022. The conference is scheduled for two days, Sunday 17th and Monday 18th. Furthermore, a panel discussion will take place on Monday 18th between the International Conference (IC) and the Technical Working Units (WUs) of IIW, connecting the two more smoothly and powerfully than ever before. After the panel discussion, all participants will be invited to a Japanese Evening event in conjunction with the “IC-WUs Exchange Reception”.

Participants will be exposed to leading-edge technologies and research in welding and joining at the new style IC linked to the JIWS 2022 before deepening their knowledge at the WUs in the Annual Assembly.

Topics of the IC will include:

- Additive Manufacturing Technology and Efficient Engineering
- Artificial Intelligence (AI) and Digital Transformation (DX)
- Hydrogen, Renewable and Nuclear Energy
- New Materials
- Future Technologies
- Other Fundamentals



Manabu Tanaka

Chairman of the Conference Organizing Committee of the 75th IIW Annual Assembly and International Conference 2022 in Tokyo, Japan

Joining and Welding Research Institute, Osaka University

Welcome to Japan

About Tokyo

Tokyo, Japan's capital, is one of the largest cities in the world with a population of roughly 14 million people. Tradition and innovation coexist in this city, where buildings and many aspects of the culture—kimono, kabuki, Japanese cuisine—retain their heritage while lifestyles continue to evolve. Rooted in Japanese culture, Tokyo, one of the world's leading tourist destinations, offers many faces and is full of allure, welcoming visitors with its exceptional hospitality. There is always something new to be discovered in Tokyo.

You can refer to the latest information on tourism in Tokyo, such as temporary closures and change of business hours of tourist facilities, and cancellation or postponement of each facility or event.

<https://www.gotokyo.org/en/>

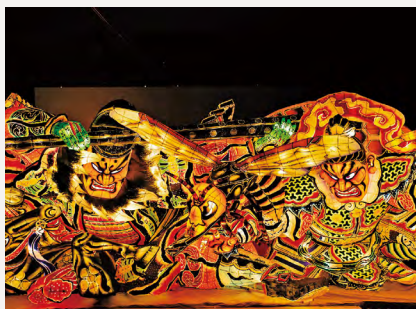



How to Get to Tokyo

Access to Japan

The nearest airports are Haneda Airport (Tokyo International Airport) and Narita International Airport. Tokyo is renowned for its extensive public transport network, operating to the exact minutes, making access to the city center from both airports convenient and hassle-free.



Registered participants in IIW2022Tokyo can enjoy the following benefits (discounted airfare). More information will be coming soon on website: <https://www.iiw2022.com/>

| AirLines | How to get the Special airlines fares? |
|---|---|
| <p>SkyTeam (AirFrance, KLM, etc.)</p>  <p>Global Meetings & Events</p> | <p>Please visit the event website or access directly through http://globalmeetings.airfranceklm.com/Search/promoDefault.aspx?vendor=AFR&promocode=38370AF</p> <p>Event: 75th IIW Annual Assembly and International Conference ID Code: 38370AF Travel Valid Period: 06/07/2022 to 29/07/2022 Event location: TOKYO</p> <p>Participants could also visit globalmeetings.airfranceklm.com and enter the event ID Code: 38370AF in order to get access to the discounted AIR FRANCE-KLM Global Meetings & Events fares.</p> |
| <p>Lufthansa-Group (Austrian Airlines, Brussels Airlines, Eurowings, Lufthansa, SWISS)</p>  | <p>The global route network of Austrian Airlines, Lufthansa, SWISS, Brussels Airlines and Eurowings offers optimal connection and combination options, so you will benefit from quick and direct flight to the event. You will reach the booking platform via this link. https://www.lufthansa.com/de/en/meetings-and-events-delegates and with the event code ITZLETE. The reduced fares are automatically displayed.</p> <p>NB: Please enable pop-ups permanently in your browser while booking, otherwise the window in the booking platform will not open. Of course, you can also book through your IATA travel agency. The travel agency can request the ticketing instructions by sending an email to lufthansa.mobility@dlh.de, stating the event code ITZLETE.</p> |



Transportation & Distance

Narita Airport

Narita Airport is the largest and busiest airport for accessing Tokyo, with hundreds of international flights arriving daily. But the airport is actually quite a long way outside of Tokyo's city center, but traveling from Narita to the center of Tokyo is possible by trains (Narita Express, or Narita Line), shuttle busses, or taxi.

<https://www.narita-airport.jp/en>

Haneda Airport

While Narita is quite far from the city center, Haneda is a refreshing breeze for those who travel a lot. Travel costs are significantly lower, and depending on your location the trip can be much faster.

Because Haneda is so close to downtown you don't have the high-end comfort option of trains like Narita Express, but faster and easier trains like Keikyu Airport Line, Tokyo Monorail will get you from the airport to the center of Tokyo quickly.

<https://tokyo-haneda.com/en/>

Public Transportations

Tokyo's public transportation system is efficient, punctual, and excellently maintained.

Most aboveground trains in central Tokyo are run by JR, and the subway system, which also runs primarily in central Tokyo, has two major operators: Tokyo Metro and Toei Subway. Then there are various private train lines that run out through the Greater Tokyo area.

The first thing you should do is purchase and charge an IC cards (Suica or Pasma) at the stations, or the JR Rail pass at the airport station.

You can find the best route including bullet train, bus, airline, and taxi from the site below, at "Japan Travel."

<https://japantravel.navitime.com/en/area/jp/route/>

JR

The Japan Rail (JR) network of trains covers the whole of the country and JR East is responsible for the network in the east of Japan including Tokyo. A number of unlimited ride passes are available that allow you to take advantage of this extensive rail network, and can be a highly economical and convenient way to travel.

Tokyo Metro

Japan is renowned for its comprehensive and efficient train network – and its underground trains are no different. Covering the whole city with more than 280 stations, Tokyo subway lines will help you get

Transportation & Distance

to almost any destination quickly and easily. The clearly color-coded map is a handy guide, and with multilingual signs in both stations and trains, riding the subway has never been simpler. Tokyo Metro and Toei Transportation offer a variety of discount tickets that are a good way to save some cash if you're traveling a lot by subway in one day.

Taxi

Taxi is the most convenient way of transportation and can be a life saver if you're lost or get stuck after the last train or bus as left the station.

Taxies can be found at taxi stands in front of stations and in front of commercial facilities. You can also grab a taxi on the move by raising your hand up in a slight waving position. Each taxi has a small, glowing LED sign on them that says whether or not they are free to take passengers.

- be sure to get on a licensed taxi and watch out for “shiro-taku”, unlicensed illegal taxis
- taxi drivers prefer to know the address of the destination in Japanese for accurate travel
- starting fare is 420 yen for the first kilometer and 80 yen added for every 237 meters
- If your trip is between 22:00 and 5:00, you are charged 20% extra.
- If you call a taxi to you, it costs dispatch fee from 300 to 420 yen .
- Taxies to Haneda and Narita Airport have flat rates. (For example, from Chiyoda-ku to Haneda Airport is 6,100 yen during normal hours and 7,200 yen during late night/early morning hours.)
- For payment, most taxi companies accept credit card as well as cash, but some taxis will not accept e-money such as Suica or Pasma.

Finding a taxi late at night can be no easy feat, even at taxi stands, so you might want to use a Japanese taxi dispatch app to get them to you.

One such app is the “Japan Taxi” app that provides information and services in Japanese, English, Simplified Chinese, Traditional Chinese, and Korean.

Access to the Venue

IIW2022: Venue

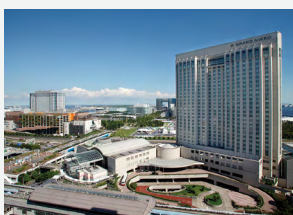

Grand Nikko Tokyo Daiba



2022 Japan International Welding Show: Venue

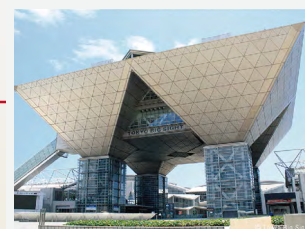

Tokyo Big Sight



Useful Information

Visa & Passport

All participants entering Japan must have a valid passport. In addition, participants coming from certain countries must have a visa issued by a Japanese embassy/consulate in their country. Please check visa requirements and updated information on COVID-19 on the website of the Ministry of Foreign Affairs of Japan (http://www.mofa.go.jp/j_info/visit/visa/index.html).

Regarding the visa support, please check on further details online at the registration page of our official website (<https://www.iiv2022.com/>).

Language

In Japan, people speak Japanese. Japanese has 3 alphabets: 'kanji' - Chinese ideograms imported from the sixth century onwards, 'hiragana' and 'katakana' - both 45 character alphabets. 'Katakana' is used mainly for foreign loanwords.

Weather

July is hot and humid in Tokyo. The average high and low temperatures are 29°C/84°F and 22°C/72°F. However, the event site is well conditioned.

Currency

Japan uses Yen (JPY: ¥). Foreign currency may be changed at airports, hotels, and banks. Card withdrawals can also be made at numerous ATMs, although not all ATMs accept foreign cards. Credit cards (Visa, Master, Diners, and Amex) are widely accepted in shops and restaurants.

Time Zone

Japan uses Japan Standard Time, which is the standard time zone for Japan and is UTC (Coordinated Universal Time)/GMT (Greenwich Mean Time) +9 hours.

Japan does not use daylight saving time. Also, there are no time differences within Japan. The time in the whole Japanese archipelago from Hokkaido to Okinawa is always the same.

Water

All throughout Japan, the tap water is safe to drink and that includes the water found in parks, gardens and public bathrooms.



Useful Information

If you prefer to drink bottled water when traveling in Japan it is also available and can be found in convenience stores or vending machines inexpensively. Bottled water in Tokyo can be mineral water or you can also purchase bottles of cold Japan tap water which are less expensive, and equally as good.

Electricity

The voltage in Japan is 100 Volt, which is lower and different from North America (120V), Central Europe (230V) and most other regions of the world. Keep in mind that the use in Japan for a device designed solely for 240V should be avoided, unless you use a step-up transformer.

Power plug and socket are all type A, and resemble North American ones. It usually come in various versions, but most commonly they are non-polarized and ungrounded with two pins, meaning the slots in the sockets are the same size.

Many appliances are compatible with a wide range of voltages, but to make sure, try looking at the back of the appliances or its charger to verify if your device or appliance is dual-voltage or not. If it can run between 100V-240V, you will just need the right power plug to connect to the power sockets used in Japan. If not, you will need a voltage converter in Japan. Major electronic retail stores such as BicCamera, Yodobashi, Yamada Denki sell variety of plugs, converters and electrical appliances. Smartphones, laptops, and digital cameras are usually built to overseas standards and will automatically adjust to the different voltage.

Telephones

You can use your mobile phone in Japan in SoftBank Mobile or DOCOMO's 5G (5th Generation) service area. All you have to do is bring your own SIM card and insert it to a rental phone or your own 3G handset. Rental phone service is also available upon arrival at Narita Airport or Haneda Airport. Toll Free Numbers start with 0120.

Emergency Contact

Dial 110 for police, 119 for Fire/Ambulance, 118 for Coast Guard, 7119 (free call) or 9110 (pay call) for Emergency question, and 171 for Safety Confirmation During Earthquake/Disaster.

Safety

Although Japan is very safe and the crime rate is quite low, if you fall victim such as theft, loss, traffic or other incident, and if you need help, visit the local koban—the small police boxes, or ask the front desk of the hotel you stay. To receive an insurance payment, a police report will be required.

Registration

Registration Fee

| Physical | Early Bird (~April 2022) | Standard (May 2022) | |
|---|--------------------------|---------------------|--------|
| Full Package | ¥140,000 | ¥150,000 | 6 DAYS |
| Full Package (Young Professional) | ¥90,000 | ¥105,000 | 6 DAYS |
| Full Package (Student) | ¥50,000 | ¥55,000 | 6 DAYS |
| International Conference only | ¥70,000 | ¥80,000 | 2 DAYS |
| International Conference only (Student) | ¥40,000 | ¥45,000 | 2 DAYS |
| Accompanying Person | ¥40,000 | ¥45,000 | 6 DAYS |

| Non-Physical (Online or On-Demand) | Early Bird (~April 2022) | Standard (May 2022) | |
|---|--------------------------|---------------------|--------|
| Full Package | ¥90,000 | ¥100,000 | 6 DAYS |
| Full Package (Young Professional) | ¥75,000 | ¥90,000 | 6 DAYS |
| International Conference only | ¥60,000 | ¥70,000 | 2 DAYS |
| International Conference only (Student) | ¥40,000 | ¥45,000 | 2 DAYS |

(¥1,000 ≅ 7.67€, 8.75US\$)

* All registration fees include of the ticket for Japan International welding Show.

*1: The "Young Professionals" category is for those under 35 years of age (as of July 17, 2022).

*2: Student rate is applicable only to those who have student status at the time of registration. Students are required to submit a scanned image file (in either jpeg or pdf format) of their student ID which shows the validity period via online registration form.

*3: Accompanying persons are limited to the participants' family members only.

Registration Entitlement

| No. | TYPE | IC Collaborative Expo Corner | Sessions | | | Social Events (Physical only) | | | |
|-----|--|----------------------------------|--------------------------|---------------|---|-------------------------------|---------------|------------------------------|--------------|
| | | Wed. - Sat. | Sun. - Mon. | Tue. - Fri. | Sun. | Mon. | Tue. | Wed. | |
| | | 13-16, Jul | 17-18, Jul | 19-22, Jul | 17-Jul | 18-Jul | 19-Jul | 20-Jul | |
| | | Japan International Welding Show | International Conference | Working Units | Young Professional Ice Breaking session | Welcome Reception | Japan Evening | Young Professionals' Evening | Gala Banquet |
| 1 | Full package | ✓ | ✓ | ✓ | | ✓ | ✓ | | ✓ |
| 2 | Full package (Young Professionals) | ✓ | ✓ | ✓ | ✓ | ✓ | ✓ | ✓ | ✓ |
| 3 | Full package (Students) | ✓ | ✓ | ✓ | ✓ | ✓ | ✓ | ✓ | ✓ |
| 4 | International Conference only | ✓ | ✓ | | | ✓ | ✓ | | |
| 5 | International Conference only (Students) | ✓ | ✓ | | ✓ | ✓ | ✓ | ✓ | |
| 6 | Accompanying Person | ✓ | | | | ✓ | ✓ | | ✓ |

Accommodation

JTB Global Marketing & Travel Inc. (GMT) has booked rooms at hotels in Tokyo for the 75th IIW Annual Assembly and International Conference period. Reservations will be processed in order of application.

| No | Hotel Name (Check-in & out time) | Room Rates Without Breakfast | | Room Rates With Breakfast | | 1. Access to the venue 2. Address 3. Phone 4. Access to closest station |
|----|--|---|----------------------------|--|----------------------------|--|
| | | Mon - Fri | Sat, Sun | Mon - Fri | Sat, Sun | |
| 1 | Grand Nikko Tokyo Daiba (15:00/12:00)   | JPY 22,200 | * JPY 28,800 JPY 35,600 | * JPY 24,400 JPY 26,400 | * JPY 31,000 JPY 40,000 | 1. Directly connected to the venue 2. 2-6-1, Daiba, Minato-ku, Tokyo 135-8701 3. +81-3-5500-6711 4. Direct connection to Daiba station on Yurikamome Line |
| 2 | Tokyo Bay Ariake Washington Hotel (14:00/10:00)   | JPY 6,440 | JPY 8,090 | JPY 8,420 | JPY 10,070 | 1. 15min walk and train 2. 3-7-11 Ariake, Koto-ku, Tokyo 135-0063 3. +81-3-5564-0111 4. 3 min walk from Kokusai-Tenjijo station on Rinkai Line |
| 3 | Sotetsu Grand Fresa Tokyo-Bay Ariake (15:00/11:00)   | JPY 9,850 JPY 11,600 (20-21 July) | JPY 12,700 | JPY 11,280 JPY 13,030 (20-21 July) | JPY 14,130 | 1. 15min walk and train 2. 3-6-6 Ariake, Koto-Ku ,Tokyo 135-0063 3. +81-3-6899-2035 4. 3 min walk from Tokyo Big Sight Station on Yurikamome Line |

◆ Room rates include service charge, 10% consumption tax and accommodation tax.

◆ “ * ” indicates single occupancy of a twin or double room.

IIW2022 Schedule

Schedule at Glance

| Wednesday ~ Friday 13 July ~ 15 July | Saturday 16 July | Sunday 17 July | Monday 18 July | Tuesday 19 July | Wednesday 20 July | Thursday 21 July | Friday 22 July |
|---|---------------------|---------------------------------------|--------------------------|-----------------------------------|-----------------------------|-----------------------------|-----------------------------|
| | | IIW General Assembly | IC-Keynote Speech | IAB-A | IAB-B | IAB Board | IIW Administrative Meetings |
| | | YP-Ice Breaking Session | IC-Sessions | IAB-B | | IAB MM | TMB Meeting *3 |
| Collaborative Expo Corner in JIWS *2 | | IC (International Conference) Opening | IC-WU's Panel Discussion | Technical WU's | Technical WU's | Technical WU's | BoD Meeting *3 |
| | BoD Meeting *3 | IC-Keynote Speech | Technical WU's | National Delegation Meeting | National Delegation Meeting | National Delegation Meeting | |
| | | Opening Ceremony | | BoD's Dinner *3 | Closing Ceremony | | |
| | | Welcome Reception | Japan Evening | YP (Young Professional)'s Evening | Gala Banquet | | |

IC: International Conference WU: Working Units IAB: International Authorization Board BoD.: Board of Directors

Program Overview

| Wednesday ~ Friday 13 July ~ 15 July | Saturday 16 July | Sunday 17 July | Monday 18 July | Tuesday 19 July | Wednesday 20 July | Thursday 21 July | Friday 22 July |
|---|-------------------------------|---|--|---|---|---|--|
| | 10:00-18:00 Registration | 8:00-18:00 Registration | 8:00-18:00 Registration | 8:00-18:00 Registration | 8:00-18:00 Registration | 8:00-18:00 Registration | 8:00-18:00 Registration |
| 10:00-18:00 Collaborative Expo Corner in JIWS *2 | | 8:30-18:00 Exhibition | 8:30-18:00 Exhibition | 8:30-18:00 Exhibition | 8:30-18:00 Exhibition | | |
| | | | 8:30-10:30 IC Keynote Lecture | 8:30-10:30 Working Units 1st Morning Session | 8:30-10:30 Working Units 1st Morning Session | 8:30-10:30 Working Units 1st Morning Session | 8:30-10:30 Administrative Session |
| | | | 10:30-11:00 Coffee Break | 10:30-11:00 Coffee Break | 10:30-11:00 Coffee Break | 10:30-11:00 Coffee Break | 10:30-11:00 Coffee Break |
| | | 10:30-12:30 General Assembly | 11:00-12:30 International Conference | 11:00-12:30 Working Units 2nd Morning Session | 11:00-12:30 Working Units 2nd Morning Session | 11:00-12:30 Working Units 2nd Morning Session | 11:00-12:30 Administrative Session |
| | | 13:00-14:30 YP Ice Breaking Session | 12:30-14:00 Lunch Break | 12:30-14:00 Lunch Break | 12:30-14:00 Lunch Break | 12:30-14:00 Lunch Break | 12:30-14:00 Lunch Break |
| | 14:00-17:15 BoD Meeting *3 | 15:00-15:15 IC Opening | 14:00-16:00 International Conference | 14:00-16:00 Working Units 1st Afternoon Session | 14:00-16:00 Working Units 1st Afternoon Session | 14:00-16:00 Working Units 1st Afternoon Session | 14:00-16:00 TMB Meeting *3 |
| | | 15:15-17:15 IC Keynote Lecture | 16:00-16:30 Coffee Break | 16:00-16:30 Coffee Break | 16:00-16:30 Coffee Break | 16:00-16:30 Coffee Break | 16:00-18:00 BoD Meeting *3 |
| | | 18:00-19:30 Opening Ceremony | 16:30-18:00 IC-WU's Panel Discussion | 16:30-18:00 Working Units 2nd Afternoon Session | 16:30-18:00 Working Units 2nd Afternoon Session | 16:30-18:00 Working Units 2nd Afternoon Session | |
| | | 19:30-22:00 Welcome Reception | 19:30-22:00 Japan Evening | 19:30-23:00 YP's Evening / BoD's Dinner | 19:30-23:00 Closing Ceremony / Gala Banquet | | |

*1 Schedule is subject to change: Extra Working Units sessions might be added prior and after the meeting week.

*2 Registered Participants for IIW annual assembly can enter to the Related Event: 2022 Japan International Welding Show at 13-16 July 2022 in Tokyo Big Sight for free.

*3 BoD Meeting and TMB Meeting are limited to invitees.

Technical Commissions & Working Units



BOARD/Board of Directors

| | |
|--------|----------------------------|
| TMB | Technical Management Board |
| CEO | Chief Executive Officer |
| WG-GOV | Governance |
| WG-FAR | Finances, Audit & Risks |

CEO/Chief Executive Officer

| | |
|-------|---------------------|
| WG-RA | Regional Activities |
|-------|---------------------|

TMB/Technical Management Board

| | |
|-------------|--------------------------------------|
| WiW EdBoard | Welding in the World Editorial Board |
| WG-TWU | Technical Working Units |
| WG-STAND | Standardization |
| WG-YL | Young Leaders |

International Authorization Board

IAB Groups

| | |
|-------------|---------------------------------------|
| IAB Board | Board of IAB |
| IAB/Group A | Education, Training and Qualification |
| IAB/Group B | Implementation, Authorization |
| IAB/MM | IAB Members Meeting |

Commissions

| | |
|---------|--|
| C-I | Additive Manufacturing, Surfacing, and Thermal Cutting |
| C-II | Arc welding and Filler Metals |
| C-III | Resistance Welding, Solid State Welding and Allied Joining Process |
| C-IV | Power Beam Processes |
| C-V | NDT and Quality Assurance of Welded Products |
| C-VI | Terminology |
| C-VII | Microjoining and Nanojoining |
| C-VIII | Health, safety and environment |
| C-IX | Behaviour of Metals Subjected to Welding |
| C-X | Structural Performances of Welded Joints - Fracture Avoidance |
| C-XI | Pressure Vessels, Boilers and Pipelines |
| C-XII | Arc Welding Processes and Production Systems |
| C-XIII | Fatigue of Welded Components and Structures |
| C-XIV | Education and Training |
| C-XV | Design, Analysis, and Fabrication of Welded Structures |
| C-XVI | Polymer Joining and Adhesive Technology |
| C-XVII | Brazing, Soldering and Diffusion Bonding |
| C-XVIII | Quality Management in Welding and Allied Processes |

IIW2022 International Conference



IIW 2022 International Conference on Welding and Joining
“Innovative Welding and Joining Technologies to achieve Carbon Neutrality and promote Sustainable Development”

Conference Presentations

4 Keynote Lectures (tentative) on Sunday 17th

- ◆ Towards Carbon Neutral & the Green Society
- ◆ Hydrogen Energy & Turbine Power Generation (for Houdremont Lecture)
- ◆ Additive Manufacturing (AM) Technologies & Manufacturing Revolution
- ◆ State-of-the-art Technologies for Light Vehicle

4 Keynote Lectures (tentative) on Monday 18th

- ◆ Offshore Wind Power Generation
- ◆ Zero-emission Ships
- ◆ Aerospace Technologies for Carbon Neutral Society
- ◆ The Future of Steel Structure Buildings by DX

Over 100 oral presentations at Around 10 Parallel sessions on Monday 18th

- ◆ Additive Manufacturing Technology and Efficient Engineering
- ◆ Artificial Intelligence (AI) and Digital Transformation (DX)
- ◆ Hydrogen (including fuel ammonia), Renewable and Nuclear Energy, Electrification
- ◆ New Materials
- ◆ Future Technologies
- ◆ Other Fundamentals

Around 20 poster presentations at Poster Sessions on Monday 18th

- ◆ The same topics with parallel sessions, mainly for young professionals & students

Collaboration with IIW journal “Welding in the World”

- ◆ “Welding in the World” publishes a Typical Collection for International Conference and includes 15~20 papers.

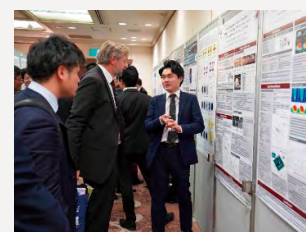

Important Dates

February 28, 2022 Deadline for abstract submission

After April, 2022 Notification to authors about status of their abstract

May 9, 2022 Submission of camera-ready manuscript

Collaborative Event

Related Event

2022 Japan International Welding Show

Date

13-16 July 2022

Organizer

The Japan Welding Engineering Society
Sanpo Publications Incorporated

Venue

Tokyo Big Sight, Tokyo, Japan

The Common Theme for both International Conference on Welding and Joining and the “Collaborative Expo Corner” in Japan International Welding Show

Innovative Welding and Joining Technologies to achieve Carbon Neutrality and promote Sustainable Development

- **What are the goals which each industry aims to realize carbon neutrality?**
 - ▶ To exhibit and grasp the future of industry at the “Collaborative Expo Corner”
- **What innovation would be required in welding and joining technologies to achieve goals?**
 - ▶ To understand the presentation at the International Conference

The special “Collaborative Expo Corner” in the Japan International Welding Show

The special exhibition will be set up within the Japan International Welding Show.

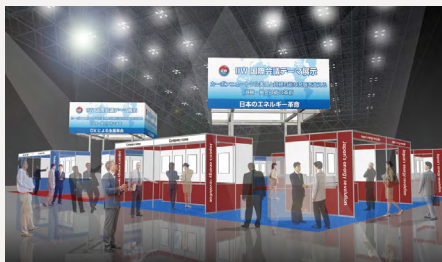
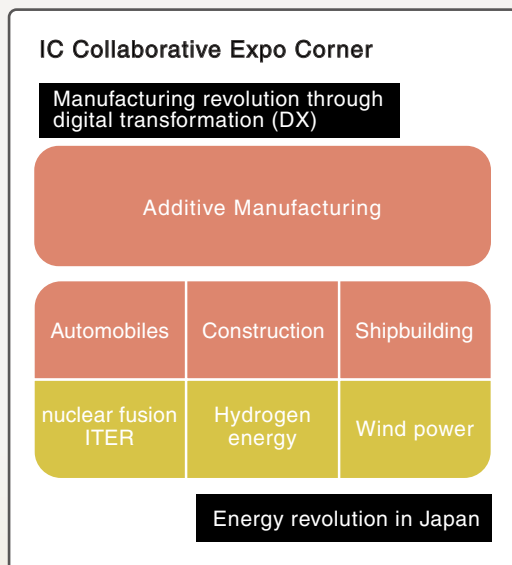

The venue plan of the Japan International Welding Show (East Hall 4 to East Hall 7)

The expo corner will be set up in the venue.

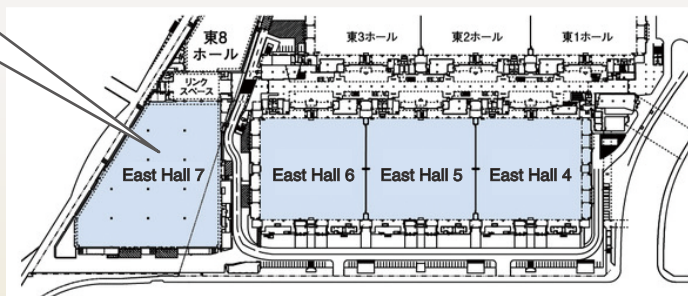

Social Plans

Sunday, July 17, 2022

13:00-14:30 Young Professional Ice Breaking Session*

A casual networking event for young professionals in buffet style.
Dress Code: Business Attire



19:30-22:00 Welcome Reception*

A welcome party where all delegates gather and meet for the first time.
Dress Code: Business Attire

Monday, July 18, 2022

19:30-22:00 Japan Evening*

A buffet styled party with the theme of "Japan". The delegates can discover Japanese culture with decorations, musical performances, and traditional food and drinks.
Dress Code: Business Casual

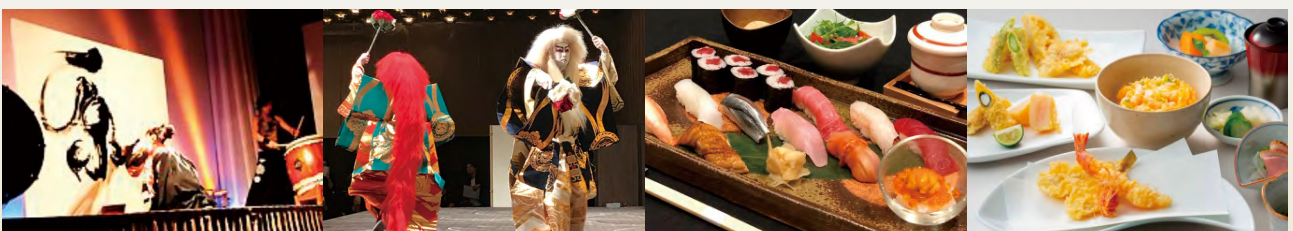

Social Plans

Tuesday, July 19, 2022

19:30-23:00 Board Directors' Dinner*

Dinner for the Board Directors
Dress Code: Business Attire



19:30-23:00 Young Professionals' Evening*

A dinner for the young professionals.
Dress Code: Casual

Wednesday, July 20, 2022

19:30-23:00 Closing Ceremony & Gala Banquet*

Dinner party to summarize and conclude
the whole event.
Dress Code: Formal



* All social events will be held at Grand Nikko Tokyo Daiba, the same venue as the conference.

Technical Visits

* The price is subject to change.

July 18, 20 and 21, 2022

| | | | | | | | | | | |
|----------------------------|----|----------------------|----|-------------|----|-------------------|----|---------------------------|----|----------------------------|
| Grand Nikko Tokyo Daiba | -- | Tokyo Gate Bridge | -- | Lunch | -- | Tokyo Sky Tree | -- | Japan National Stadium | -- | Grand Nikko Tokyo Daiba |
| 10:30 | | 11:00/11:30 | | 12:00/13:00 | | 13:30/15:10 | | 15:50/16:20 | | 17:00 |

■ Req. to Run Tour : 20 guest(s)

■ JPY 16,400/per person

Tokyo Gate Bridge

A bridge with a total length of 2618m, also known as the "Dinosaur Bridge", facing Tokyo Bay.

After passing the bridge by bus, you can walk along the promenade of the bridge.

You can see the truss structure with a unique shape up close.



Japan National Stadium

Designed by architect Kengo Kuma and used as the main stadium for the Tokyo 2020 Olympic and Paralympic Games.

The stadium is known for its Japanese design and harmonizing with the Meiji Shrine Forest.

Tokyo Sky Tree

The world's tallest self standing broadcasting tower was completed in February 2012. The height is 634m with cutting-edge Japanese building technology.

In this tour, you can enter the basement of the tower.

You can observe the welded part and touch the pillars.



©TOKYO-SKYTREE

Grand Nikko Tokyo Daiba

BALLROOM

B1F Palais Royal

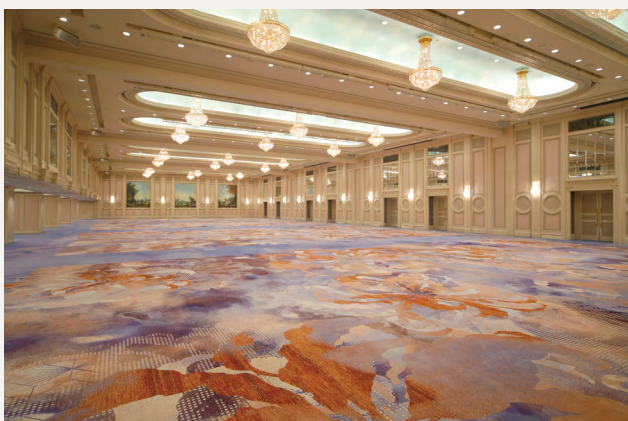

2-3F Atrium



BANQUET ROOM

Châtelet



Vendôme



Étolie



Fantaisie



Harmonie



Concerto



Grand Nikko Tokyo Daiba

BANQUET ROOM

Menuet



Pensée



Ginga



Niji



Akane



Hikari

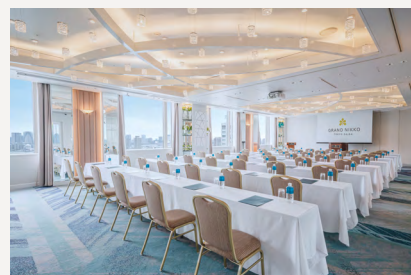

Akatsuki



Grand Nikko Tokyo Daiba

Floor Map

B1F

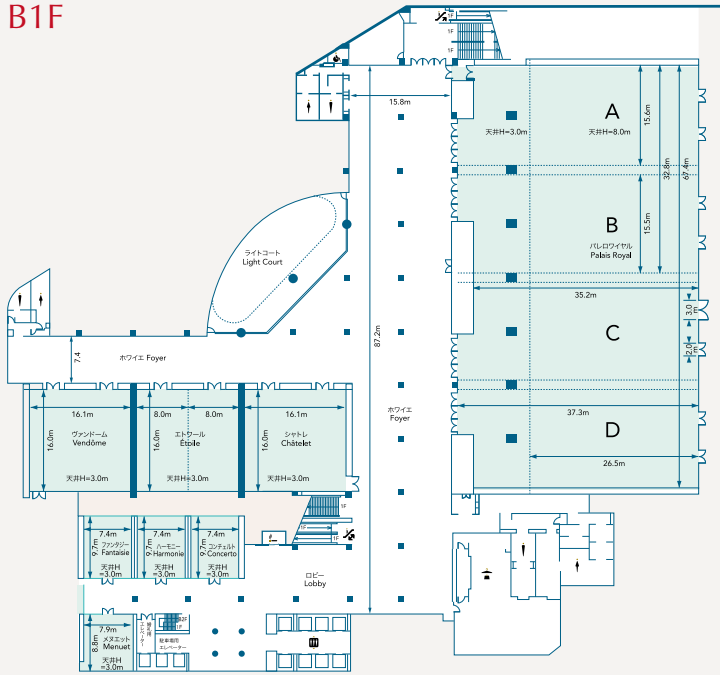

1F

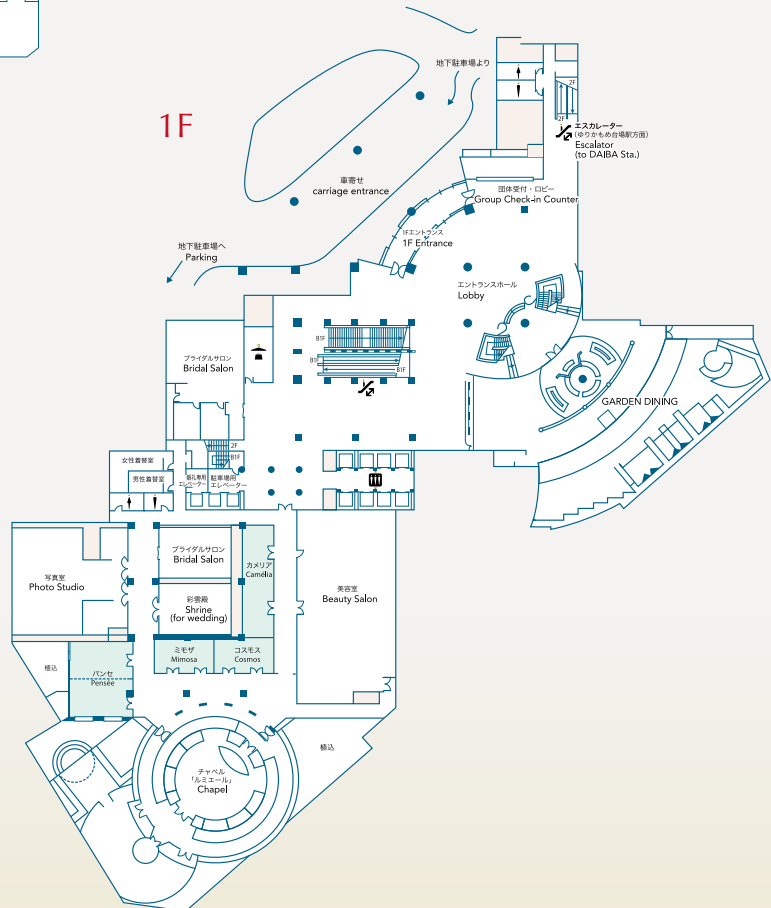

Grand Nikko Tokyo Daiba

Floor Map

2-3F

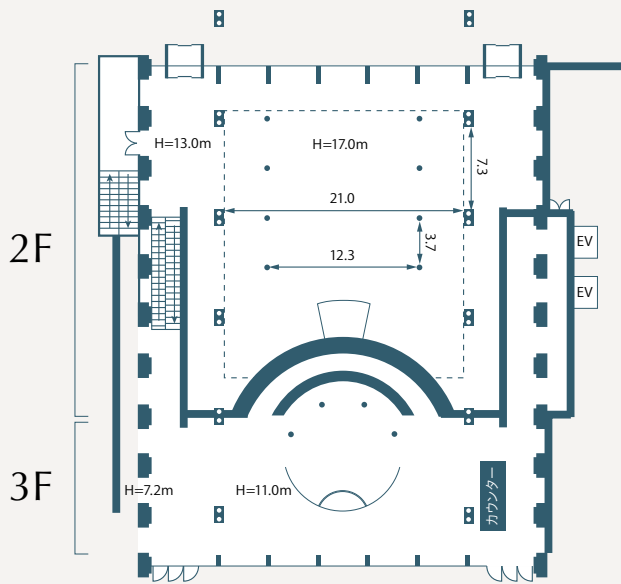

29F

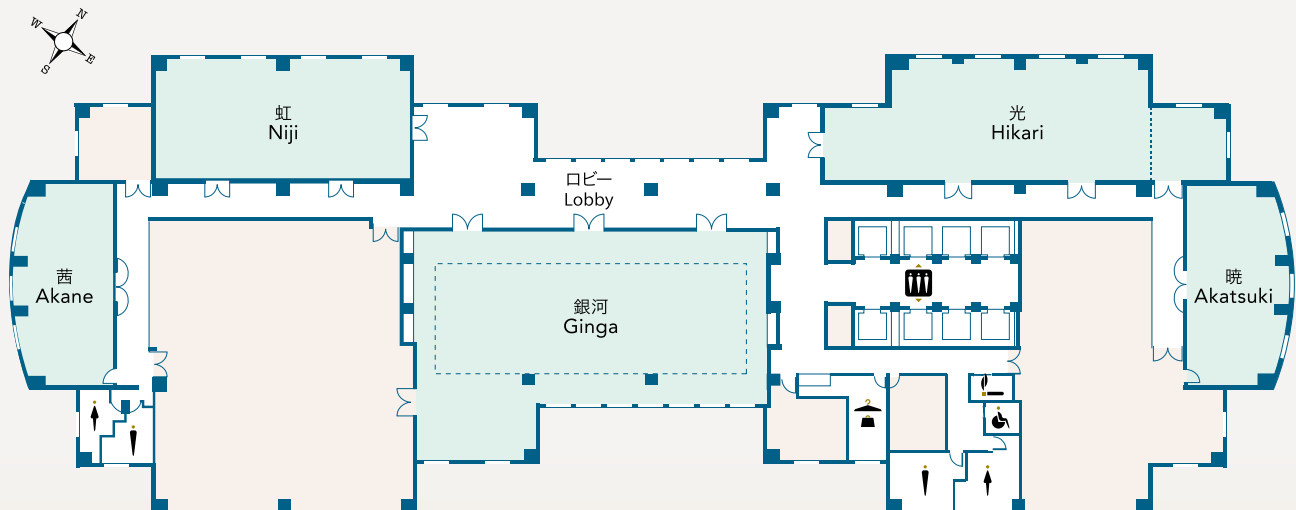

IIW Member Countries



The IIW members worldwide

IIW currently has 51 member countries, with some countries having several welding associations or organisations sharing joint membership.

| | | | |
|---|----------------|---|----------------------------|
|  | AUSTRALIA |  | NORWAY |
|  | AUSTRIA |  | PAKISTAN |
|  | BELGIUM |  | PEOPLE'S REPUBLIC OF CHINA |
|  | BULGARIA |  | POLAND |
|  | CAMEROON |  | PORTUGAL |
|  | CANADA |  | REPUBLIC OF KAZAKHSTAN |
|  | CROATIA |  | REPUBLIC OF KOREA |
|  | CYPRUS |  | ROMANIA |
|  | CZECH REPUBLIC |  | RUSSIAN FEDERATION |
|  | DENMARK |  | SERBIA |
|  | FINLAND |  | SINGAPORE |
|  | FRANCE |  | SLOVAK REPUBLIC |
|  | GERMANY |  | SLOVENIA |
|  | GHANA |  | SOUTH AFRICA |
|  | GREECE |  | SPAIN |
|  | HUNGARY |  | SWEDEN |
|  | INDIA |  | SWITZERLAND |
|  | INDONESIA |  | THAILAND |
|  | IRAN |  | THE NETHERLANDS |
|  | ITALY |  | TUNISIA |
|  | JAPAN |  | TURKEY |
|  | MALAYSIA |  | UKRAINE |
|  | MEXICO |  | UNITED KINGDOM |
|  | MOROCCO |  | UNITED STATES OF AMERICA |
|  | NEW ZEALAND |  | VIETNAM |
|  | NIGERIA | | |

For the latest list, please visit the website below:
<http://iiwelding.org/iiw-members>

Sponsors

PLATINUM

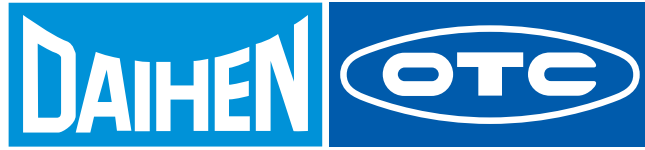

Iwatani



NIPPON STEEL WELDING & ENGINEERING CO.,LTD.

Panasonic CONNECT



GOLD



The Japan Welding
Material Association



Sponsors

SILVER

ClassNK

 **DENGENSHA TOA**

 **JFE**

KOBELCO

TANAKA
TAIYO NIPPON SANSO GROUP

YASKAWA

BRONZE

 **DAIHATSU**

HONDA
The Power of Dreams

ISUZU

 **MAZDA**

 **MITSUBISHI MOTORS**

 **NISSAN**

 **SUBARU**

 **SUZUKI**

TOYOTA

 **DAIDO STEEL**

Denyo[®]

HITACHI
Inspire the Next

JAPEIC
JAPAN POWER ENGINEERING AND INSPECTION CORPORATION

 **KOIKE**

KOMATSU

SANPO
PUBLICATIONS, INC.

 **USUKI**
SHIPYARD

ITEM SPONSORS

 **AMPI**

 **JEOL**

FUNDRAISERS

 **Japan Light Metal
Welding Association**

Foundation for the
Promotion of Welding and
joining Engineering

 一般社団法人
全国鐵構工業協会
Japan Steel Fabricators Association

 一般社団法人
鉄骨建設業協会
JAPAN STEEL CONSTRUCTORS ASSOCIATION

 **JSSC** JAPANESE SOCIETY
OF STEEL
CONSTRUCTION

Supported by

Tokyo Convention & Visitors Bureau

CONTACT

Japan Institute of Welding (c/o The Japan Welding Engineering Society)

4-20 Kandasakumacho, Chiyoda-ku, Tokyo 101-0025 Japan

Phone: +81-3-5823-6322

FAX: +81-3-5823-5244

E-mail: iiw2022@jwes.or.jp